



# TWO SOLID THEATRES IN ZAGREB

Vjera Katalinić

Croatian Academy of Sciences and Arts, Zagreb

# Pejačević – Kulmer – Amadé theatre 1797-1834

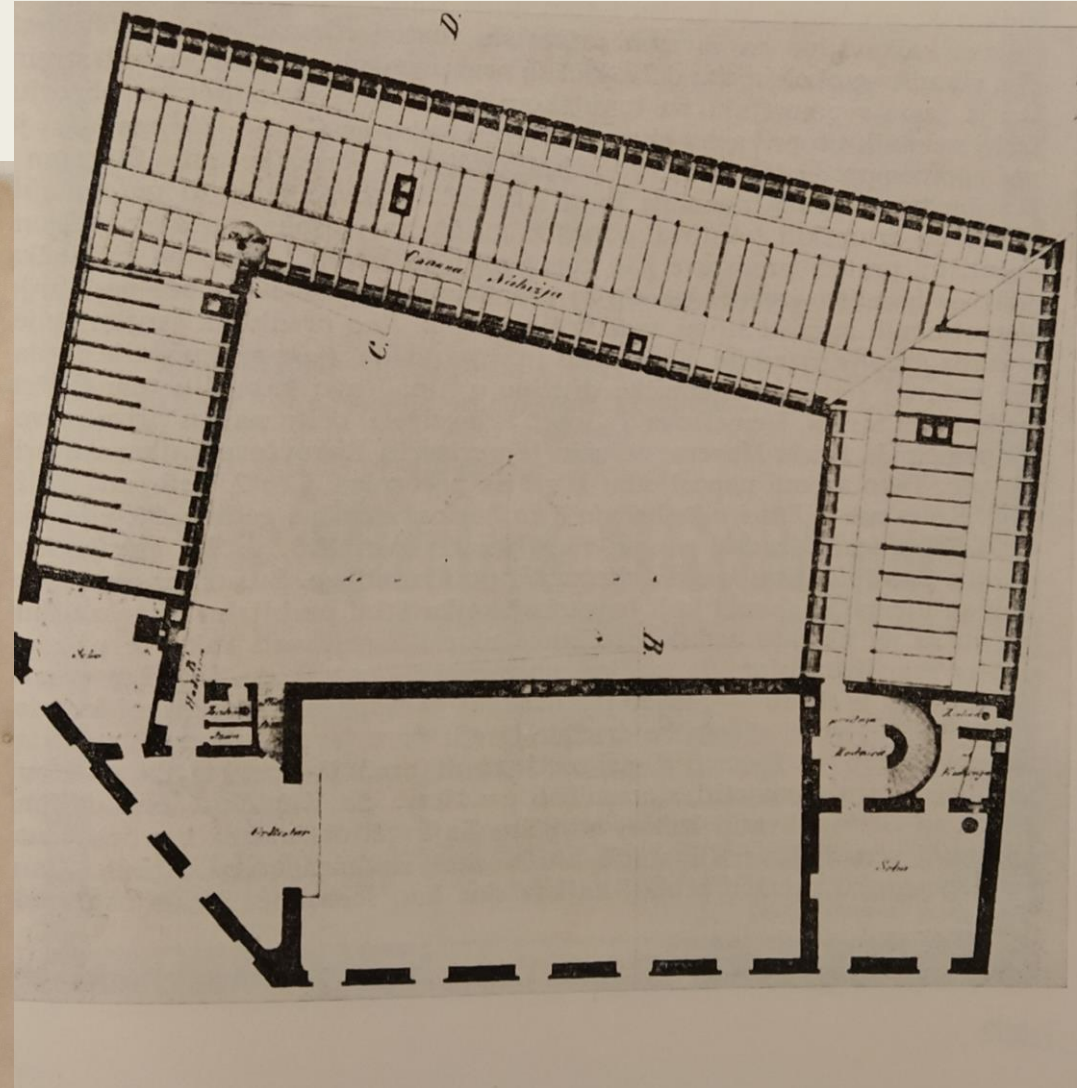

# Most important impresarios

- **Constantin de Parascowitz, from Sopron, 1797**
- **Barbara Krapf, from Graz, 1797-99**
- **Adams, from Graz, 1802-1803**
- **Josef Bubenhofer, 1803-1817**
- **Lorenz Gindel, 1818-1822**
- **Karl Rosenschön & co., 1825-1828**
- **Karl Mayer, 1830-1834**

# Kristofor Stanković, theatre built by Christoph & Anton Cragolini 1834-1880/1895

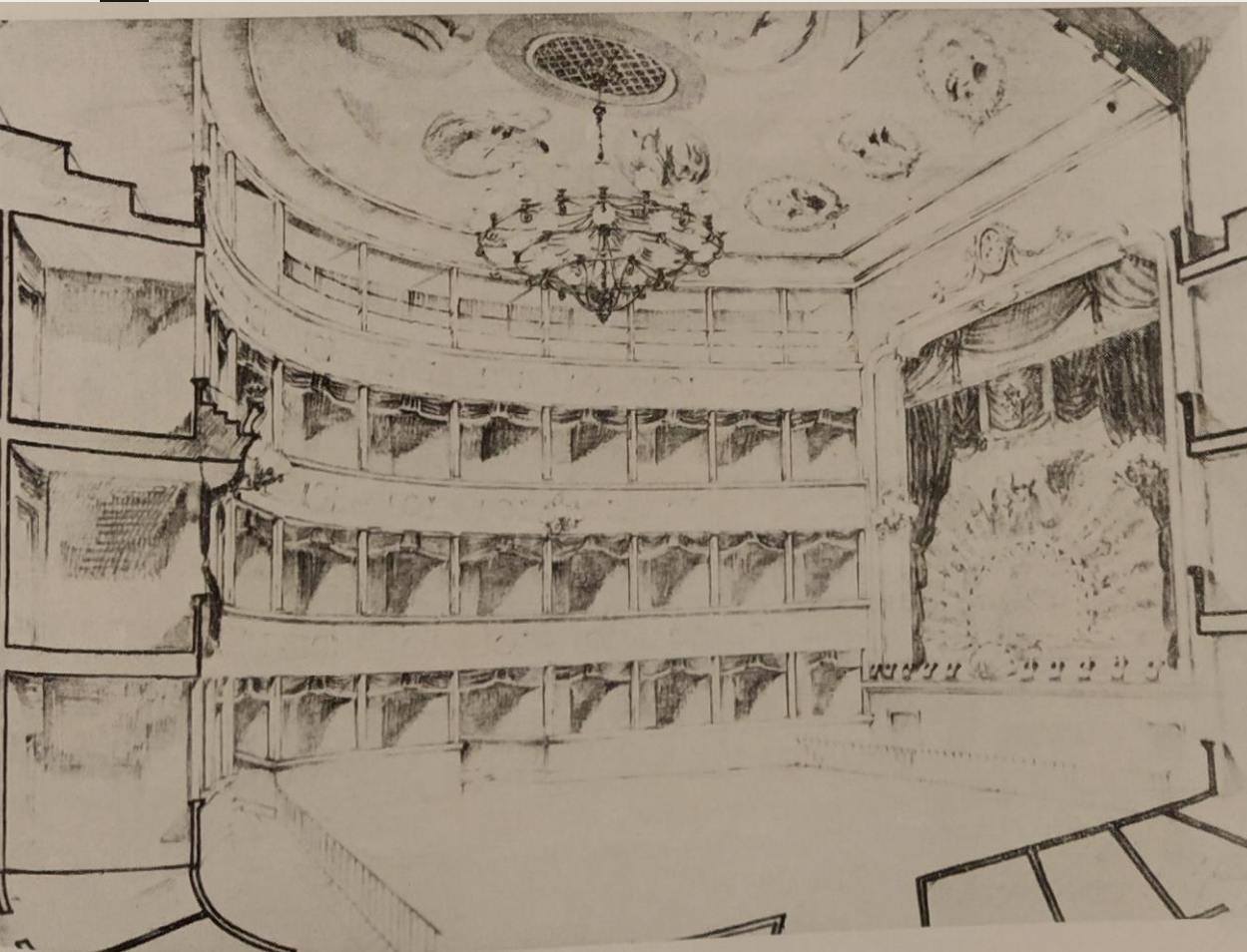

# Most important impresarios

- Franz Anton Zwoneczek, 1834-1835
- Lucas Martinelli, 1835-1836
- Joseph Schweigert, 1836-1837
- Karl Mayer, 1838-1839, 1842
- Heinrich & Karl Börnstein, 1839-1841
- Joseph Glöggl, 1841
- Vincenz Schmidt, 1841-1842, 1842-1843
- Joseph Lingg, 1843
- Eduard Freyberg, 1844-1845
- Karl Rosenschön, 1845-1846, 1847-1848
- Georg Wimmer, 1846-1847
- Ludwig Schwarz, 1850

# Most important impresarios – cont.

- Ferdinand Gruber, 1850-1851
- Karl Folness, 1853
- Theaterkomitee, 1854-1855
- Rudolf Stefan, 1855-1856, 1857
- Karl Adolf Blattner, 1856-1857
- Joseph Röder, 1857-1858
- Hugo Walburg, 1858-1859
- Antun August Roll, 1859-1860
- Ulisse Brambilla, 1860

# Most important impresarios – cont.

- 1860 – **Ulisse Brambilla** (Milano): **Donizetti** (Poliuto, La Favorita, Gemma di Vergy), **Verdi** (Trovatore, Traviata),
- 1860 – **István Reszlér** (Budapest): **Donizetti** (Lucia di L., Linda di Chamonix), **Verdi** (Rigoletto, Ernani, I due foscari, Trovatore); **Erkel** (Hunyady László), **Császár** (A kunok)
- 1861 – **(Carlo) Raffaele Burlini** (Trst): **Donizetti** (Lucrezia Borgia), **Verdi** (Trovatore, Norma, Ernani, Louise Miller)
- 1862 – **(C.) R. Burlini** (Trst): **Verdi** (Ernani, Trovatore); **Donizetti** (Lucia di L., Elisir d'amore); **Rossini** (Barbiere di S.)
- 1863 – none
- 1864 – none; rejected: widow Brambilla, Andreazzi (Udine), Giuseppe Bernasconi (Milano) and Roggi
- 1865 – **Giovanni Battista Andreazzi** (Udine): **Verdi** (Trovatore); **Donizetti** (Lucia di L., Lucrezia Borgia); **Apoloni**: (L'Ebreo), **Bellini** (Montechi e Capuletti)
- 1866 – **G. B. Andreazzi** (Udine): **Verdi** (Rigoletto); **Pedrotti** (Tutti in maschera); **Bellini** (Sonnambula); **Strmić** (La madre slava); **Ricci** (Crispino e la comare); rejected: Dottore Gardani (Rijeka/Fiume)
- 1867 – none; rejected: Francesco Tirini (Padua), Burlini (Trst)
- 1868 – none; rejected: Cambiaggio (Milano), Johann Radler (Vöslau)
- 1869 – **Alessandro Betti** (Milano), taken over by Andreazzi, who's executive director became Faber: **Verdi** (Un ballo in maschera, Ernani); **Bellini** (Norma); **Donizetti** (Lucrezia Borgia, Maria di Rohan); **Petrella** (Jona); rejected: Vernici (Bucarest)

# Two solid theatres – today



19-20th March 2021, Cluj-Napoca